

The background features a large, abstract green shape on the left side, composed of many thin, overlapping lines that create a sense of depth and movement. On the right side, there are several green geometric shapes, including a large arrow pointing right and a smaller arrow pointing left, both made of multiple overlapping layers.

# **SELECTION GUIDE**

**for AMF Series Coriolis Mass Flowmeters**

---



# Contents

---

**P 1**

## **1. Product Brief Introduction**

**P 2**

## **2. Technical Overview & Specifications**

**P 2**

### **2.1 Coriolis Mass Flow and Density Meters**

**P 4**

### **2.2 Transmitter & Computer**

**P 4**

### **2.3 Nominal Diameter & Flow-rate**

**P 5**

### **2.4 Installation & Weight**

**P 10**

## **3. Sales Network**

# 1. Product Brief Introduction

## AMF Series Coriolis Mass Flow Meters

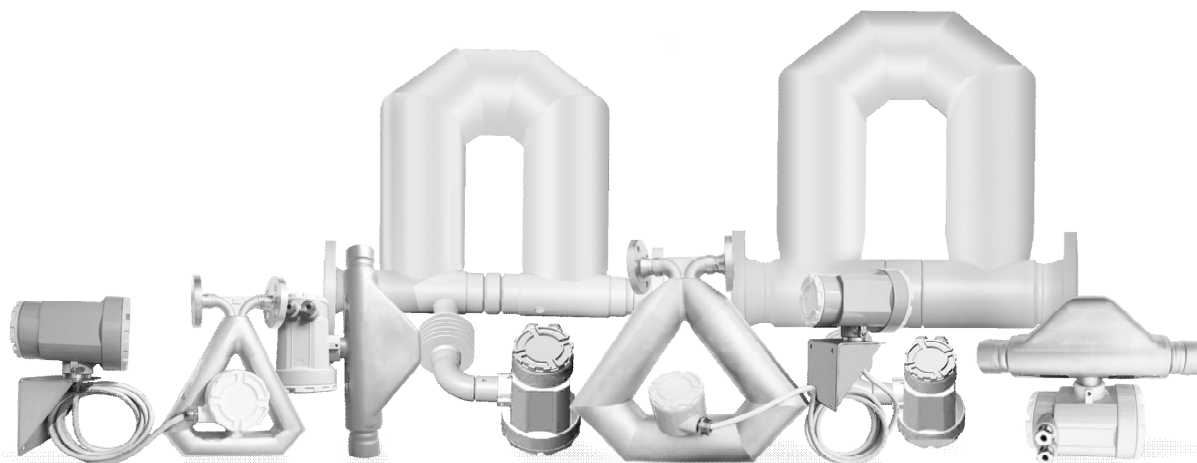

- Leading technology.
- Engaged in technology innovation, Supply the best solution for complex measuring and superior performance.
- Wide range of flow-rate products.
- Supply a wide measuring range of flow-rate and density, can satisfy the measuring demand for any process/application and fluid.
- The concept of analog signal converter.
- The same elections apply for all the housing design.
- The housing aimed at pressure protect is a standard configured.
- Type of protection: Ex d ib II BT5.

## 2. Technical Overview Specifications

### 2.1 Coriolis Mass Flow and Density Meters

	AMF008-10	AMF015-25	AMF020-25	AMF025-6	AMF050-4	AMF080-4
<b>Application type</b>	Continuous control, Loading/unloading/mixed, Trade transition					
<b>Flow-rate accuracy</b>						
<b>Accuracy</b>	Grade 0.15, Grade 0.2, Grade 0.5, Grade 1.0					
<b>Repeatability</b>	0.075%, 0.1%, 0.25%, 0.5%					
<b>Density</b>	$\pm 0.001 \text{g/cm}^3$					
<b>Temp.</b>	$\pm 34^\circ\text{F}$ ( $\pm 1^\circ\text{C}$ )					
<b>Measuring Medium</b>						
<b>Normal</b>	Gas/Liquid					
<b>Pressure</b>						
<b>Max.W.P</b>	100bar	250bar	250bar	60bar	40bar	40bar
<b>Measuring medium temperature</b>						
<b>Medium temp.</b>	-320°F to +158°F	-40°F to +158°F	-40°F to +158°F	-320°F to +158°F	-320°F to +158°F	-320°F to +158°F
<b>Ambient temp.</b>	-13°F to +131°F (-25°C to +55°C)					
<b>Relative humidity</b>	$\leq 95\%$					
<b>Material</b>						
<b>Meter tube material</b>	316L					
<b>Housing material</b>	304, ZL401 ( Transmitter )					
<b>Ingress protection</b>						
<b>Mark</b>	IP56					
<b>Mounting location/type</b>						
<b>Field mounted</b>	Transmitter is separated from flowmeter	Transmitter is Integral with flowmeter	Transmitter is Integral with flowmeter	Transmitter is separated from flowmeter	Transmitter is Integral with flowmeter	Transmitter is Integral with flowmeter
End conn.termn.type (provide customized service)						
<b>Type and rating</b>	Flanged DN15 PN40	G 1" ( internal thread )	G 3/4" ( internal thread )	Flanged DN25 PN40	Flanged DN50 PN40	Flanged DN80

### Model AMF008-10



**Apply to:**  
Petrochemical,  
New Energy,  
Smelting industry,  
Drink,  
Environmental  
monitoring,  
Medical,  
Automobile,  
paper pulp,  
Cryogenic  
manufacturing.

### Model AMF015-25



**Apply to:**  
Petrochemical,  
New Energy,  
Smelting industry,  
Drink,  
Environmental  
monitoring.

### Model AMF020-25



**Apply to:**  
Petrochemical,  
New Energy,  
Smelting industry,  
Drink,  
Environmental  
monitoring.

### Model AMF025-6



**Apply to:**  
Petrochemical,  
New Energy,  
Smelting industry,  
Drink,  
Environmental  
monitoring,  
Medical,  
Automobile,  
paper pulp,  
Cryogenic  
manufacturing.

### Model AMF050-4



**Apply to:**  
Petrochemical,  
New Energy,  
Smelting industry,  
Drink,  
Environmental  
monitoring,  
Medical,  
Automobile,  
paper pulp,  
Cryogenic  
manufacturing.

### Model AMF080-4

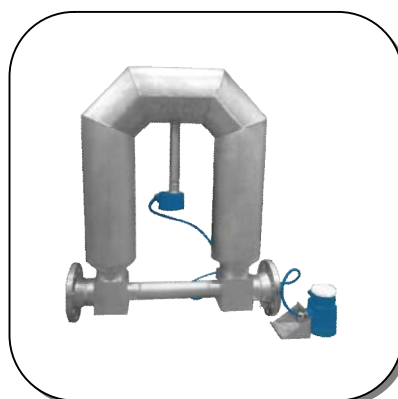

**Apply to:**  
Petrochemical,  
New Energy,  
Smelting industry,  
Drink,  
Environmental  
monitoring,  
Medical,  
Automobile,  
paper pulp,  
Cryogen  
manufac

## 2.2 Transmitter & Computer

<b>Output variables</b>	Mass and volume flow-rate, Temperature of meter tube, Density.
<b>Power supply</b>	15~36VAC/DC
<b>Output signal</b>	Modbus, 4~20mA, Pulse
<b>Ambient temp.</b>	-25°C~+55°C
<b>Mounting location</b>	Only field mounting available if transmitter is separated from flowmeter
<b>Type of protection</b>	Mark: Ex d ib IIB T5

## 2.3 Nominal Diameter & Flow-rate

Model	Nominal diameter		Max. flow-rate			
	inch	mm	Lb/min	gal/min	Kg/h	l/h
AMF008-10	$\frac{1}{4}$	DN8	55	6.6	1,500	1,500
AMF015-25	$\frac{1}{2}$	DN15	88	10.6	2,400	2,400
AMF020-25	$\frac{3}{4}$	DN20	264	31.7	7,200	7,200
AMF025-6	1	DN25	550	66	15,000	15,000
AMF050-4	2	DN50	2203	264	60,000	60,000
AMF080-4	3	DN80	5727	687	156,000	156,000

## 2.4 Installation & Weight

Dimension units: inch (mm)

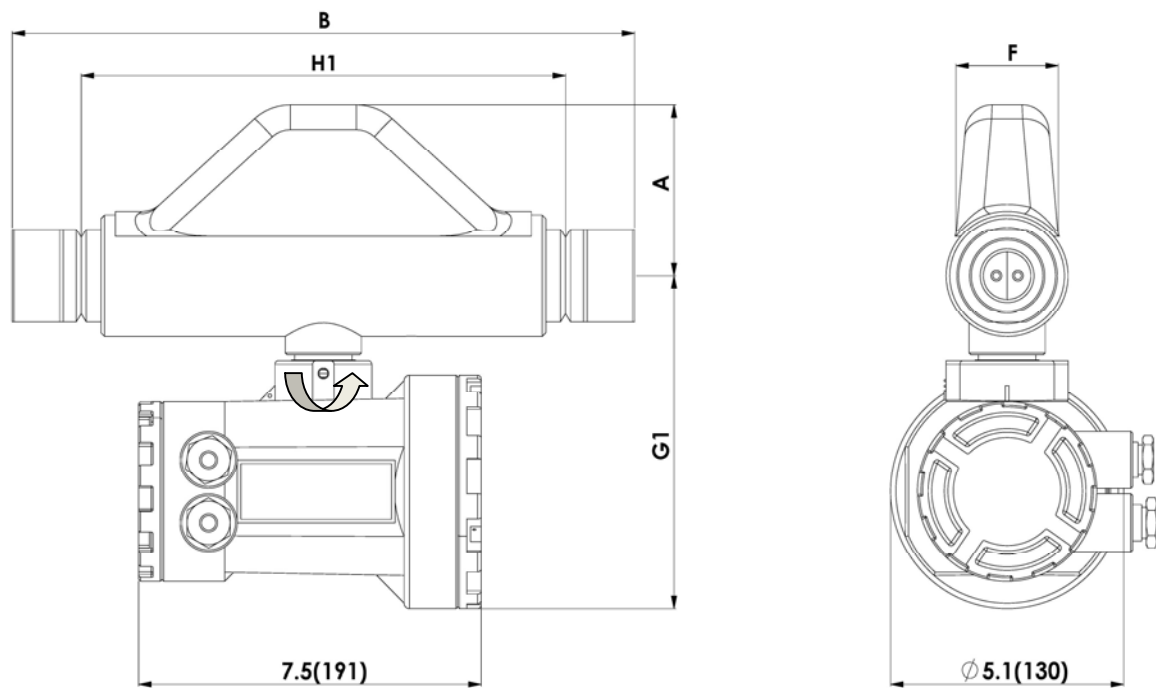

Picture 1 Model AMF015-25/AMF020-25

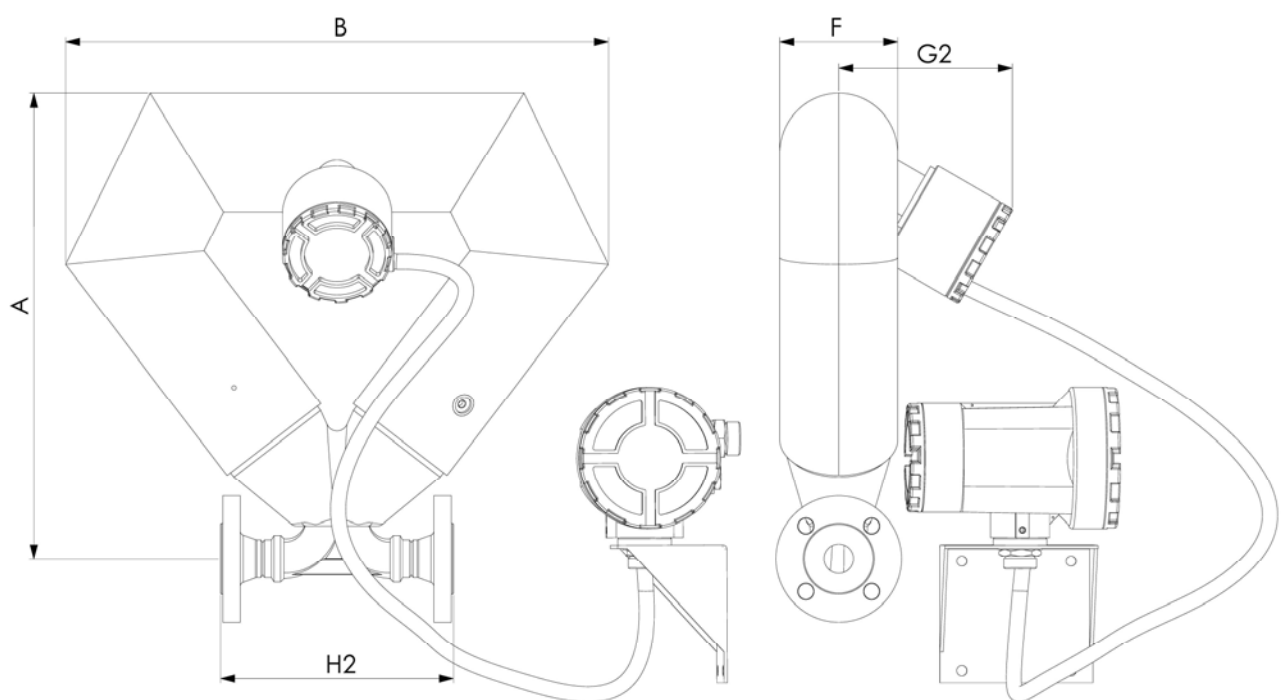

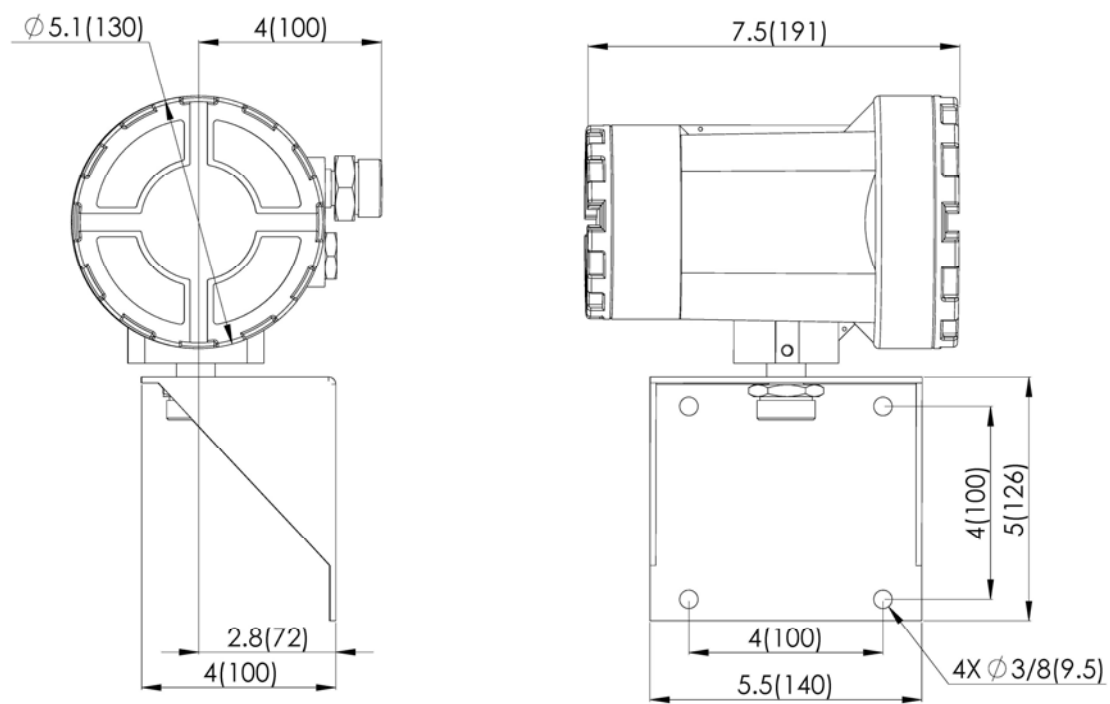

Picture 2 Model AMF008-10/AMF025-6

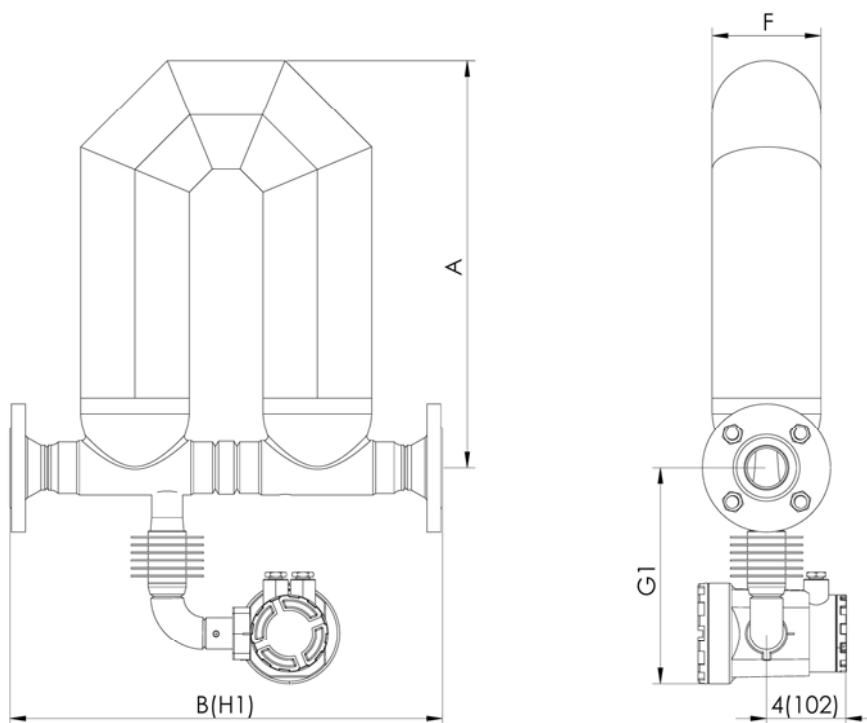

Picture 3 Model AMF050-4/AMF080-4

## Corresponding table of overall dimensions:

\*Deviation:  $\pm 5/64$  inch ( $\pm 2$  mm)

Metric units (SI)

Model	A	B	F	H		G	
				H1	H2	G1	G2
AMF008-10	291	285	$\varnothing 50$	—	162	—	92
AMF015-25	95	347	57	270	—	185	—
AMF020-25	124	427	67	350	—	187	—
AMF025-6	426	496	$\varnothing 108$	—	212	—	159
AMF050-4	525	557	$\varnothing 140$	557	—	280	—
AMF080-4	848	657	$\varnothing 168$	657	—	311	—

Units: mm

Imperial units (US)

Model	A	B	F	H		G	
				H1	H2	G1	G2
AMF008-10	11-29/64	11-7/32	$\varnothing 1-31/32$	—	6-5/16	—	3-5/8
AMF015-25	3-3/4	13-21/32	2-1/4	10-5/8	—	7-9/32	—
AMF020-25	4-7/8	16-13/16	2-41/64	13-25/32	—	7-23/64	—
AMF025-6	16-25/32	19-17/32	$\varnothing 4-1/4$	—	8-5/16	—	6-17/64
AMF050-4	20-43/64	21-59/64	$\varnothing 5-1/2$	21-15/16	—	11	—
AMF080-4	33-7/16	25-55/64	$\varnothing 6-39/64$	25-55/64	—	12-1/4	—

Units: inch

## Mounting orientation:

Model	Measurement for gas	Measurement for liquid
AMF008-10	Horizontal upward/ Vertical	Horizontal downward/ Vertical
AMF015-25	Horizontal upward/ Vertical	Horizontal downward/ Vertical
AMF020-25	Horizontal upward/ Vertical	Horizontal downward/ Vertical
AMF025-6	Horizontal upward/ Vertical	Horizontal downward/ Vertical
AMF050-4	Horizontal upward/ Vertical	Horizontal downward/ Vertical
AMF080-4	Horizontal upward/ Vertical	Horizontal downward/ Vertical

**Measuring medium: gas**

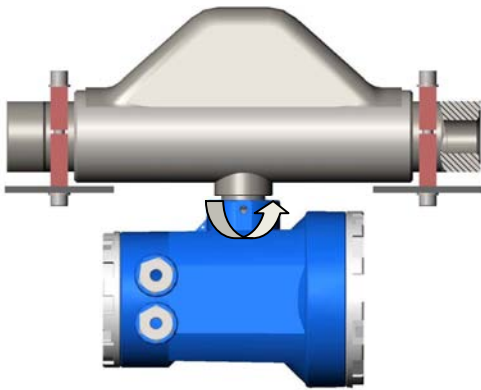

**Measuring medium: liquid**

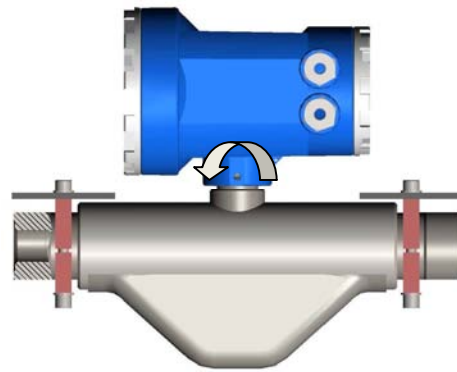

Model AMF015-25 and AMF020-25 installed on steady steel sheets, forbid upside down.

**Measuring medium: gas**

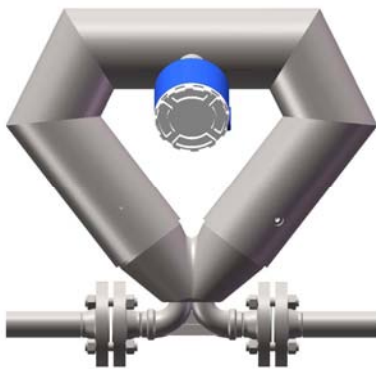

**Measuring medium: liquid**

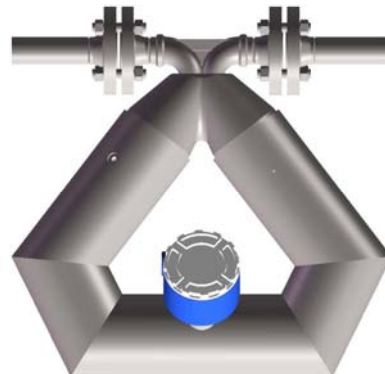

Model AMF008-10 and AMF025-6 installed on steady steel sheets, forbid upside down.

**Measuring medium: gas**

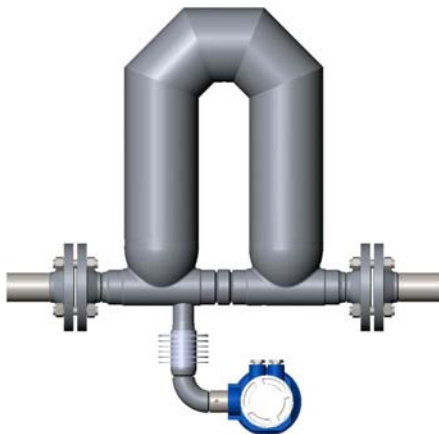

**Measuring medium: liquid**

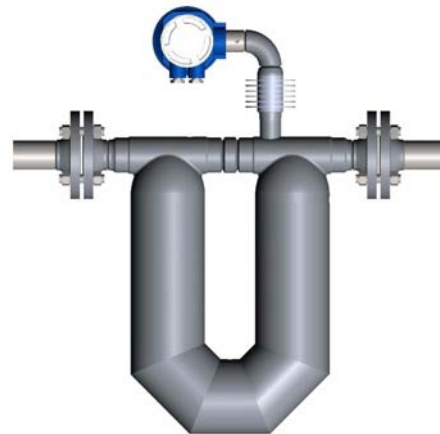

Model AMF050-4 and AMF080-4 installed on steady steel sheets, forbid upside down.

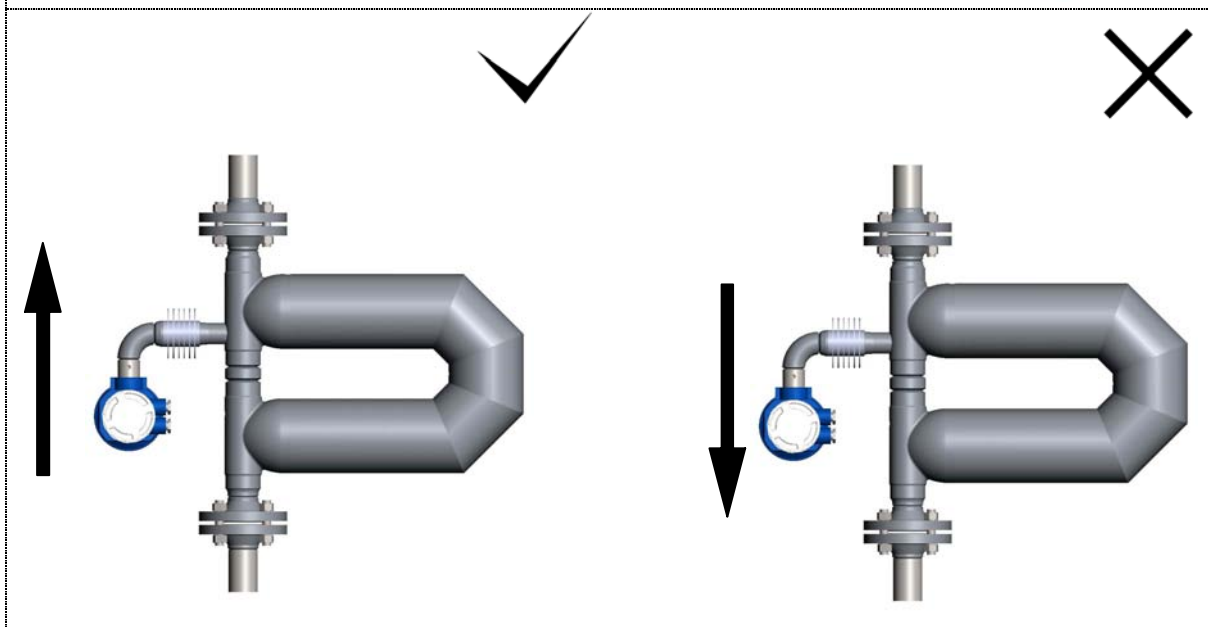
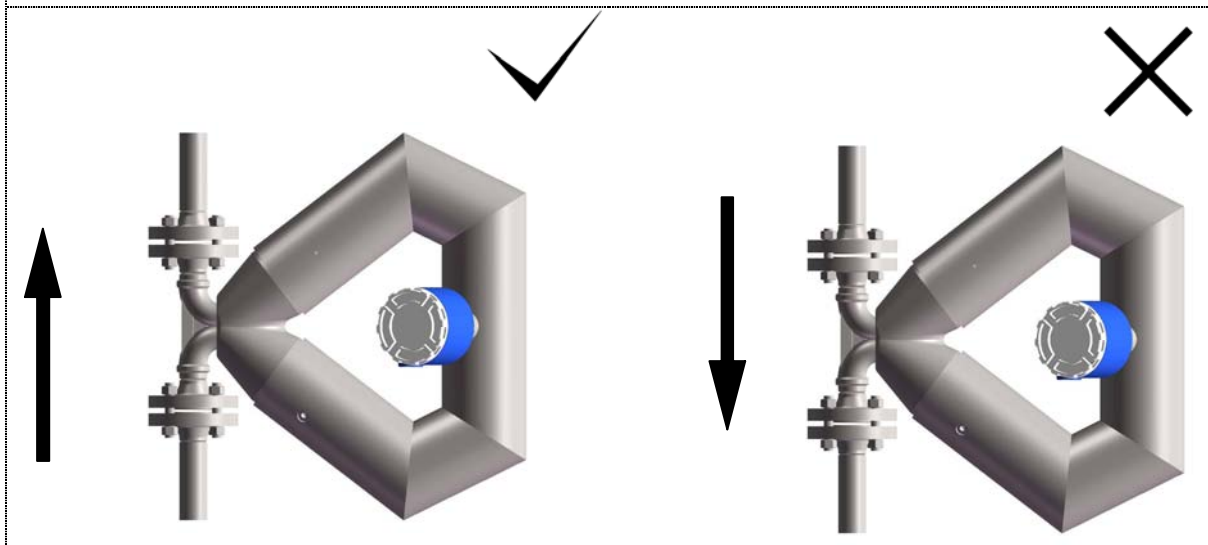
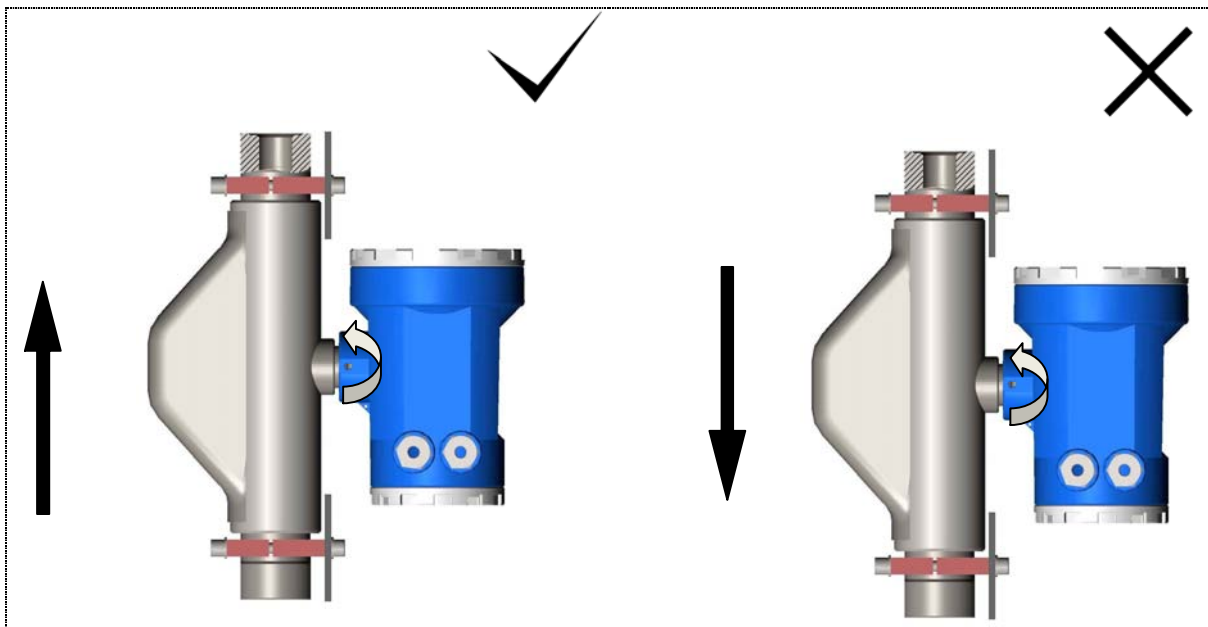

If flowmeter must be installed vertically, the direction of flow must be bottom-top.

## Weight:

Model		AMF008-10	AMF015-25	AMF020-25	AMF025-6	AMF050-4	AMF080-4
Weight	Lb	27.3	25.1	29.5	43	102.4	190.5
	Kg	12.4	11.4	13.4	19.5	46.5	86.5

## 3.Sales Network

